

Materials Clevis Clip

ME-8245

For Use with the Materials Testing Machine (ME-8236)

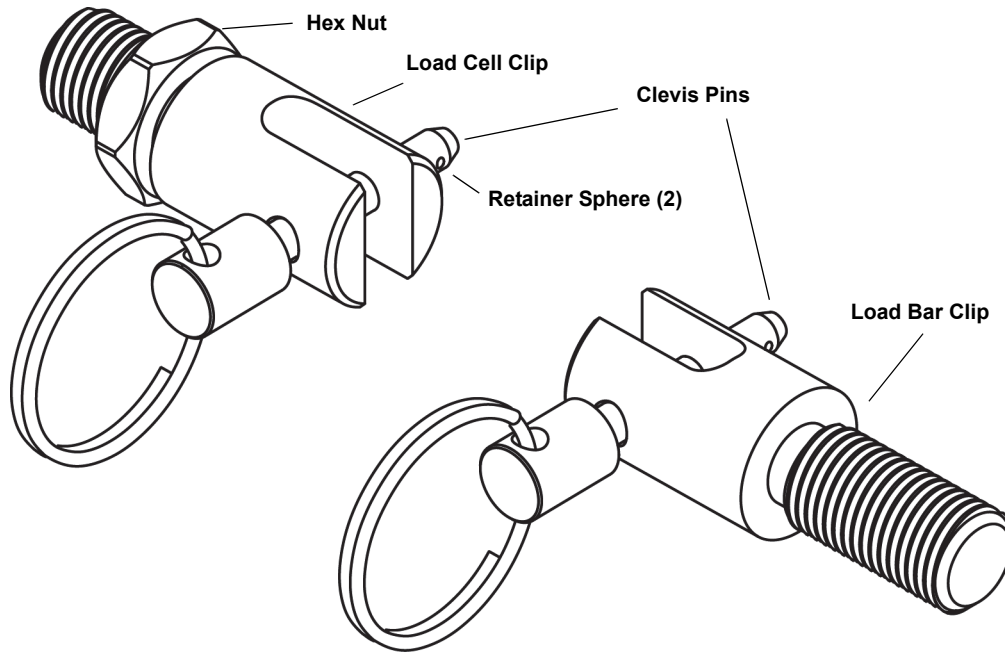

Included Items
Materials Clevis Clip
Hex Nut, M12 6 mm thick

Recommended Items*
Materials Testing System (ME-8230)
Materials Testing System Accessories*
PASCO Data Collection System*
Hooke's Law Spring Set (SE-8749)

*See the PASCO catalog or web site at WWW.PASCO.COM

Introduction

The Materials Clevis Clip is designed to work with the PASCO Materials Testing Machine (ME-8236), part of the Comprehensive Materials Testing System (ME-8244). The Materials Testing Machine is a device for measuring force

and displacement for various materials as the materials are stretched, compressed, sheared, or bent. The Materials Testing Machine has a built-in load cell (strain gauge transducer) capable of measuring up to 7100 newtons (N) of force (1600 pounds), and an optical encoder module that measures displacement of the load bar. Force data from the load cell and displacement data from the encoder module can be recorded, displayed, and analyzed through a PASCO Interface with PASCO Data Collection Software. The sensor cable from the Materials Testing Machine connects to a PASPORT interface such as the PS-2100A USB Link (not included).

Materials Clevis Clip (ME-8245)

The Materials Testing System Clevis Clip is designed to tensile test a wide variety of samples that have hooked ends or through holes. The diameter of each clevis pin is 0.187 in (0.47 cm). Each pin contains a pair of small, spring-loaded spheres near its end to keep the pin from slipping out of the clip.

The Clevis Clip with the longer threaded section is mounted in the Load Bar of the Materials Testing Machine, and the Clevis Clip with the shorter threaded section and the hex nut is mounted in the top of the Load Cell.

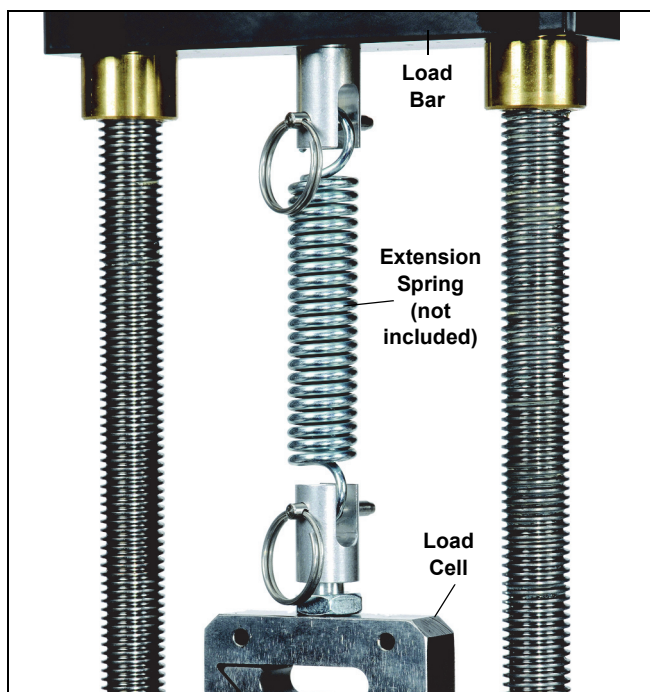

Setup

Put the longer threaded end of the upper Clevis Clip up through the hole in the Load Bar and use the Load Bar Sample Nut to secure the clip in place. Screw the shorter threaded end of the lower Clevis Clip into the top of the Load Cell.

Use the rings to pull each clevis pin partway out of the Clevis Clip. Mount the ends of the sample to be tested on the clevis pins, and push the pins back through each Clevis Clip.

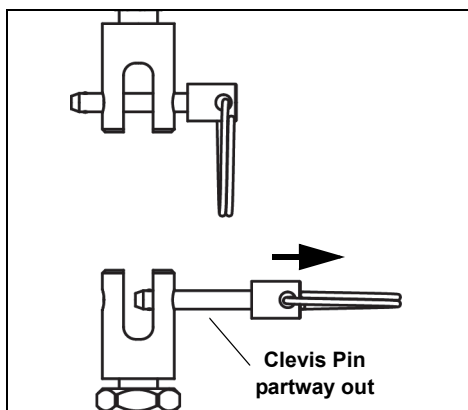

Experiment Guide

NOTE: An Experiment Guide in electronic format for the Materials Testing System is available to download from www.pasco.com.

Enter “Materials Testing System” in the Search window and look for the down-loadable file(s) under “User Resources”.

Other Equipment

Other accessories are available separately for the Material Testing Machine. Please see the PASCO web site at www.pasco.com for more information.

Technical Support

For assistance with any PASCO product, contact PASCO at:

Address: PASCO scientific
10101 Foothills Blvd.
Roseville, CA 95747-7100

Phone: +1 916-462-8384 (worldwide)
800-373-0300 (U.S.)

E-mail: support@pasco.com

Web www.pasco.com

For the latest information about the Materials Clevis Clip, the Materials Testing System, or the replacement items and accessories, go to the PASCO web site at www.pasco.com and enter the model number or the model name in the search window.

Limited Warranty For a description of the product warranty, see the PASCO catalog. **Copyright** The PASCO scientific *Instruction Sheet* is copyrighted with all rights reserved. Permission is granted to non-profit educational institutions for reproduction of any part of this manual, providing the reproductions are used only in their laboratories and classrooms, and are not sold for profit. Reproduction under any other circumstances, without the written consent of PASCO scientific, is prohibited. **Trademarks** PASCO, PASCO Capstone, PASPORT, SPARK Science Learning System, SPARK SLS, and SPARKvue are trademarks or registered trademarks of PASCO SCIENTIFIC, in the United States and/or in other countries. For more information visit www.pasco.com/legal.